

CAD Re-assembly instructions

for our neutral CAD file formats

Product: Profile cylinder, Series PRA

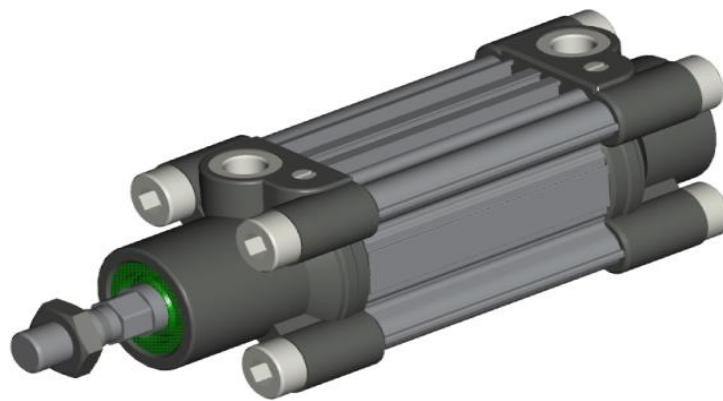

Consists of following parts: 5 pcs

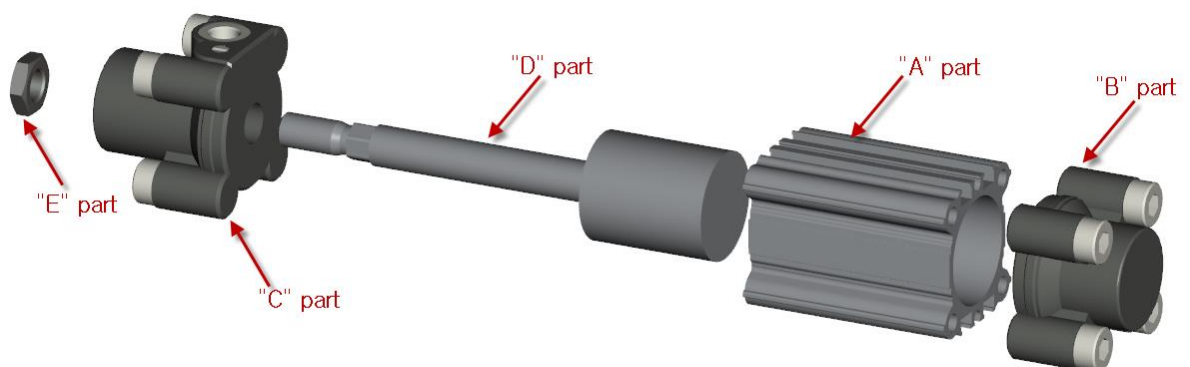

Mate instructions, step by step for easy handling

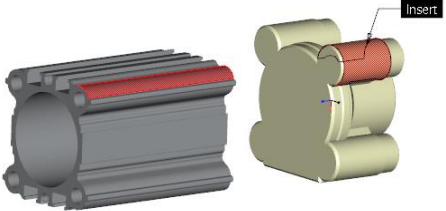
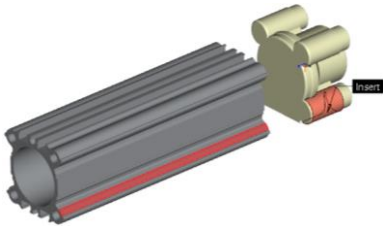
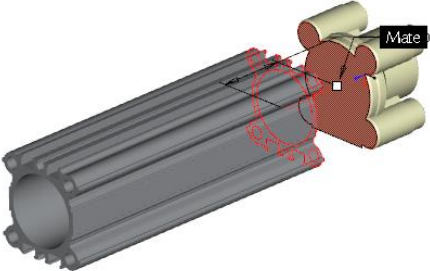
1 - Assemble A & B part.		Parts assembled: 2 (5)
	Constraint 1(3) : Insert 	
Constraint 2(3) : Insert 		Constraint 3(3) : Mate 

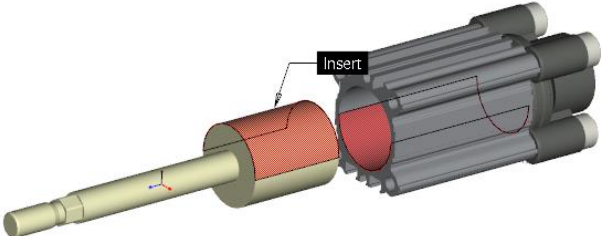
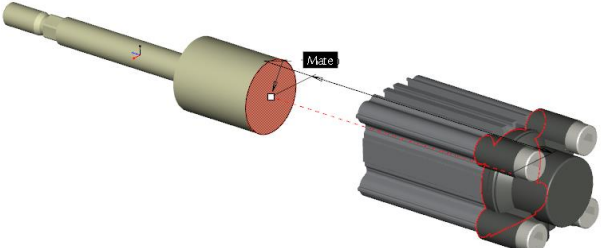
2 - Assemble D part.		Parts assembled: 3 (5)
	Constraint 1(2) : Insert 	
Constraint 2(2) : Mate 		

Mate instructions, step by step for easy handling

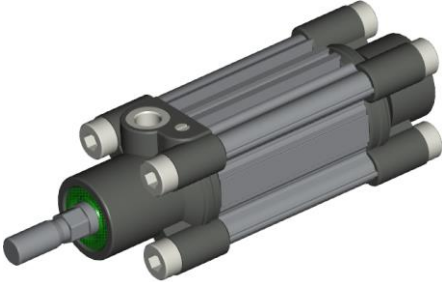
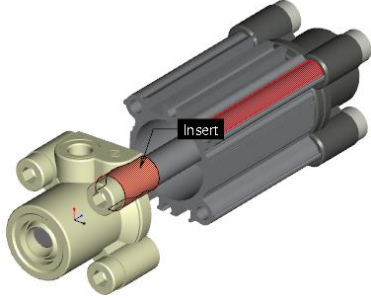
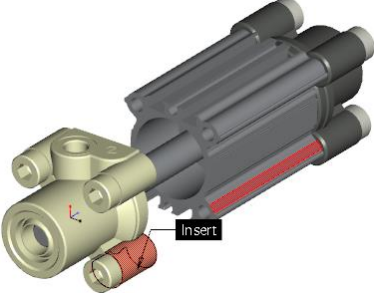
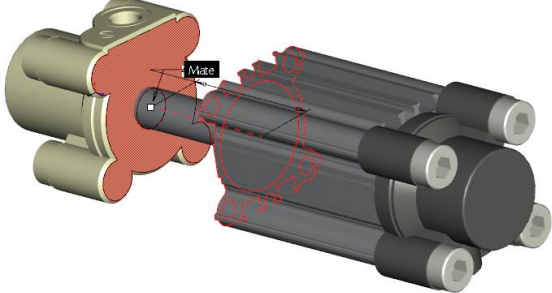
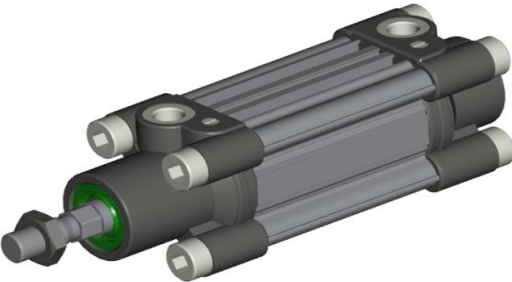
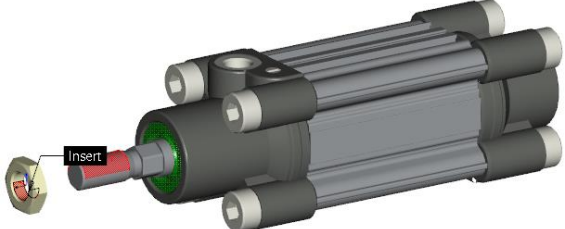
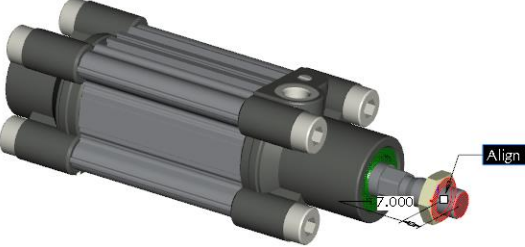
3 - Assemble C part.		Parts assembled: 4 (5)
	<p>Constraint 1(3) : Insert</p> 	
<p>Constraint 2(3) : Insert</p> 	<p>Constraint 3(3) : Mate</p> 	
4 - Assemble E part.		Parts assembled: 5 (5)
	<p>Constraint 1(2) : Insert</p> 	
<p>Constraint 2(3) : Align (X mm)</p> 	<p><i>* The X dimension is free adjusted upon using purposes</i></p>	