

Pneumatic connection technologies ▶ Push-In fittings

Series QR1-S standard

▶ Y - push-in fitting, reducing, double ▶ pin bushing ▶ Ø 4 ▶ push-in fitting, 4x ▶ Ø 6 - Ø 8 ▶ QR1-S-RY4

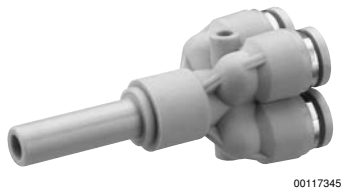

Ambient temperature min./max.
Working pressure min./max.

+0 °C / +60 °C
-0.95 bar / 10 bar

Materials:

Screw
Housing
Seal
Tooth lock washer
Release ring
Release ring holder

nickel-plated
Polybutyleneterephthalate
Acrylonitrile Butadiene Rubber
Stainless steel
Polyoxymethylene
Die cast zinc; Brass, nickel-plated

Technical Remarks

- The series QR1 (plastic) and QR2 (metal) can not be combined
- For further information about assembling and tolerances of adaptable tubing, see the section "Technical information".

Dimensions

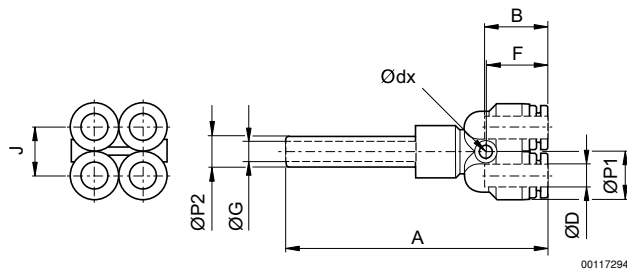

Part No.	Port G	Port D	Ødx	A	B	F	J	ØP1	ØP2	Delivery quantity [Piece]	Weight [kg]
R412005341	Ø 4	Ø 6	3.2	55.2	16	14.2	10.4	10.4	13	10	0.0128
R412005342	Ø 4	Ø 8	3.5	59.7	16	16.9	10.4	10.4	13	10	0.0135