

## Pneumatic connection technologies ▶ Push-In fittings

### Series QR1-S standard

▶ Straight plug connector, reducing ▶ push-in fitting ▶ Ø 6 - Ø16 ▶ push-in fitting ▶ Ø 4 - Ø 12 ▶ QR1-S-RSR



00117313

Ambient temperature min./max.  
Working pressure min./max.

+0 °C / +60 °C  
-0.95 bar / 10 bar

**Materials:**

Screw  
Housing  
Seal  
Tooth lock washer  
Release ring  
Release ring holder

nickel-plated  
Polybutyleneterephthalate  
Acrylonitrile Butadiene Rubber  
Stainless steel  
Polyoxymethylene  
Die cast zinc; Brass, nickel-plated

#### Technical Remarks

- The series QR1 (plastic) and QR2 (metal) can not be combined
- For further information about assembling and tolerances of adaptable tubing, see the section "Technical information".

#### Dimensions

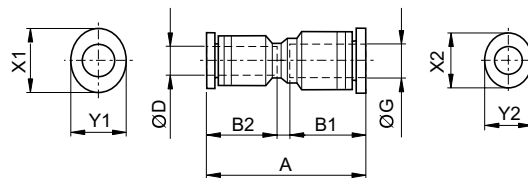

00117248

Part No.	Port G	Port D	A	B1	B2	X1	X2	Y1	Y2	Delivery quantity [Piece]	Weight [kg]
<b>R412005060</b>	Ø 6	Ø 4	34.9	17	16	14	12	12	10	10	0.0052
<b>R412005061</b>	Ø 8	Ø 4	37.2	18.5	17	16	12	14	10	10	0.0131
<b>R412005062</b>	Ø 8	Ø 6	37.2	18.5	17	16	14	14	12	10	0.0069
<b>R412005063</b>	Ø 10	Ø 6	41	21	18.5	19	14	17	12	10	0.0202
<b>R412005064</b>	Ø 10	Ø 8	41	21	18.5	19	16	17	14	10	0.0109
<b>R412005065</b>	Ø 12	Ø 8	45	22.5	21	23	16	21	14	10	0.0289
<b>R412005066</b>	Ø 12	Ø 10	45	22.5	21	23	19	21	17	10	0.0164
<b>R412005067</b>	Ø 16	Ø 12	51.8	24.8	22.5	27	23	24	21	5	0.0272